

Technical drawing of a split ring for a sheave, showing dimensions and material specification.

**Material:** SHEAVE ALUMINIUM ALLOY

**Dimensions:**

- Overall width: 68
- Overall height: 50
- Inner diameter: 65 D/A.
- Outer diameter: 57 D/A.
- End flange width: 10
- End flange thickness: 1.5
- End flange hole diameter: 8.2/8 D/A.
- End flange hole offset: 2.5
- End flange hole diameter: 2.5 mm D/A. HOLE FOR A SPLIT RING
- End flange hole offset: 10
- End flange hole diameter: 11
- End flange hole offset: 4 R.

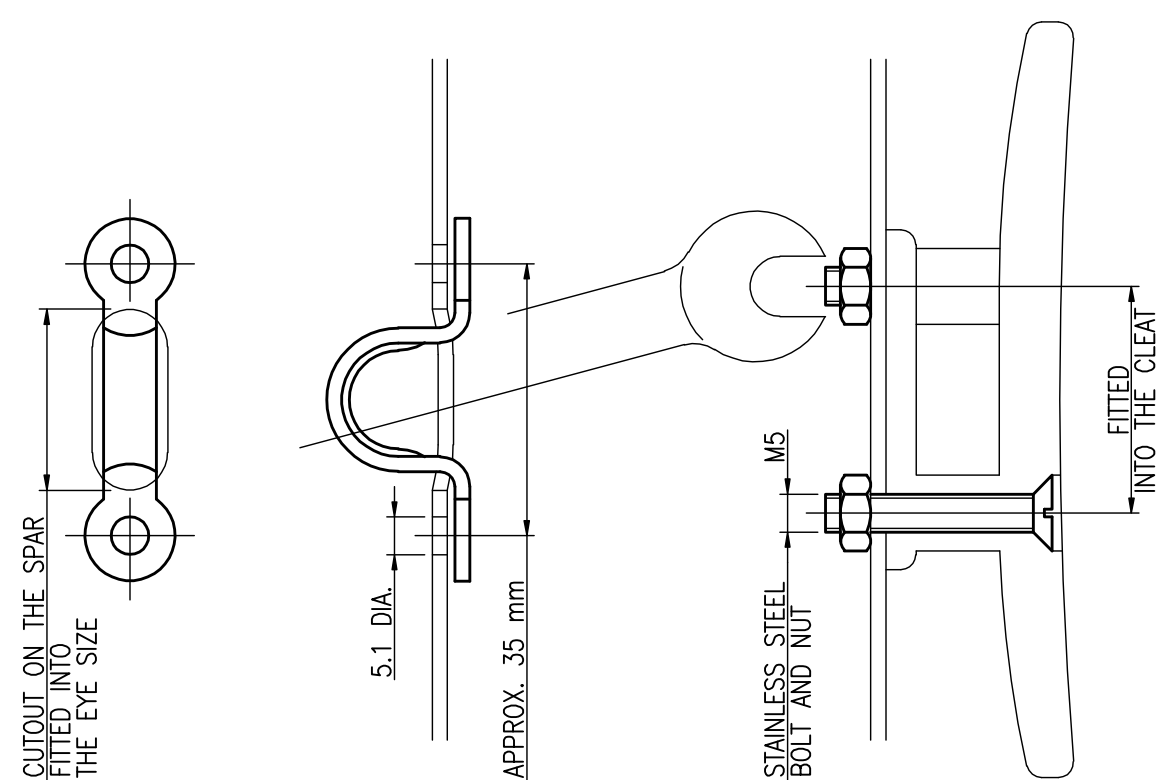

STOCK EYE FASTENED TO  
THE INNER SIDE OF THE SPAR  
WITH 5 x 10 mm POP RIVETS

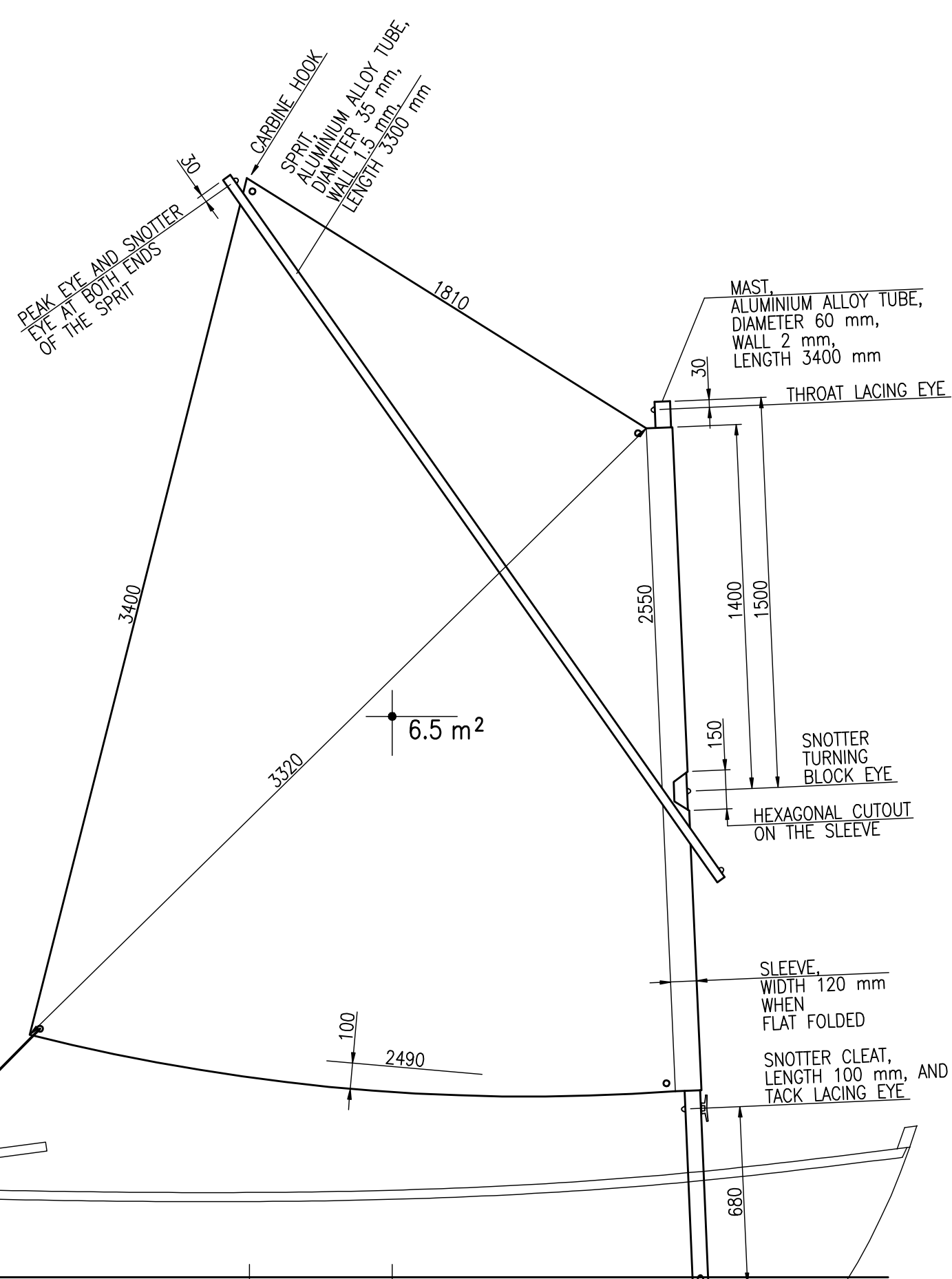
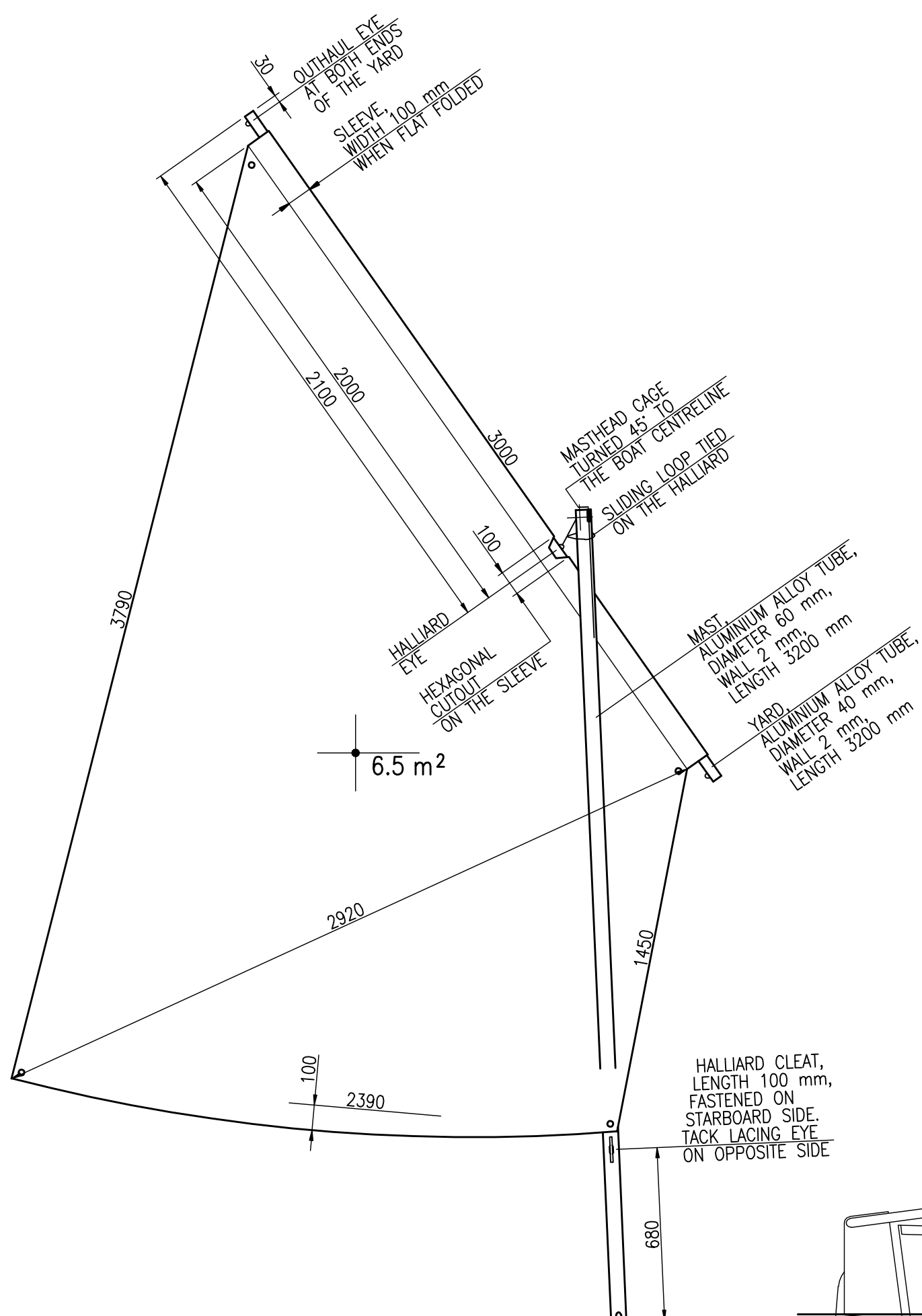

ROPE RIGGING		
MAINSHEET	10 mm	BRAIDED MATT POLYESTER
DAGGERBOARD HANDLE	8 mm	PLAITED OR BRAIDED POLYESTER
MAIN HALLIARD SNOTTER	5 mm	
THROAT LACING		
TACK LACING		
OUTHauls		
RUDDER BLADE UPHaul		

4.2m

SAILS AND SPARS  
SHEET 42.3/4, SIZE A2  
SCALE 1:1, 1:20

RADOSŁAW WERSZKO  
JANUARY 2011, NOVEMBER 2012